

MATERIAL NUMBER	LED BACKLIGHT COLOR	DESCRIPTION
79540-5015	BLUE	470nm ±10nm
79540-5016	AMBER	587nm ±8nm

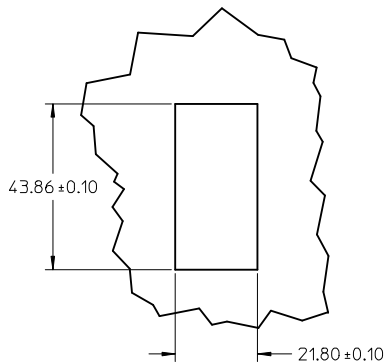

RECOMMENDED PANEL
THICKNESS: MIN: 3.36mm
MAX: 3.81mm
MEDIAN: 3.51mm

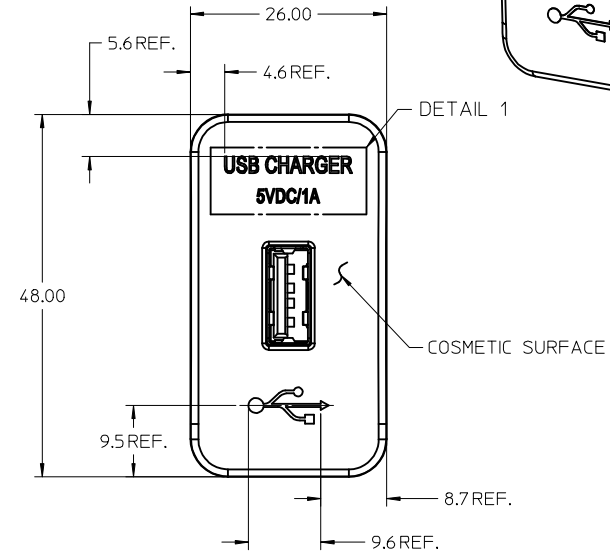
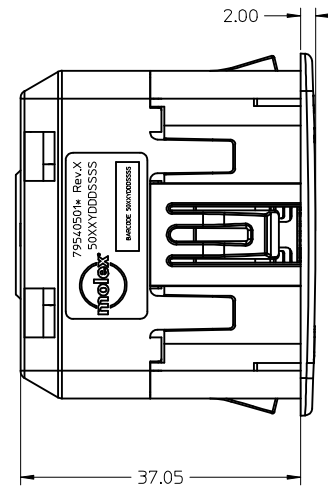
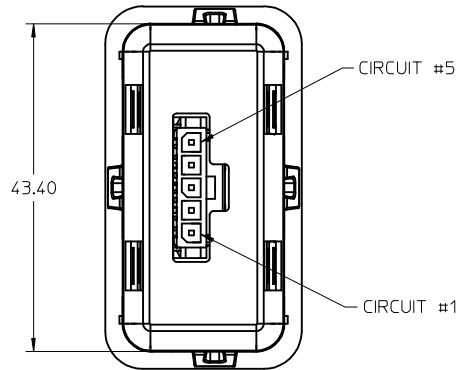
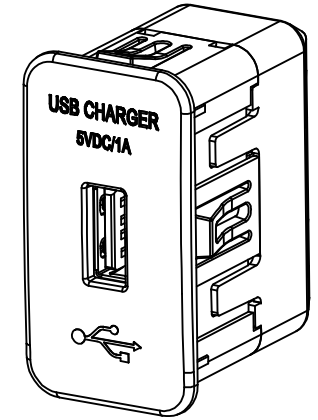
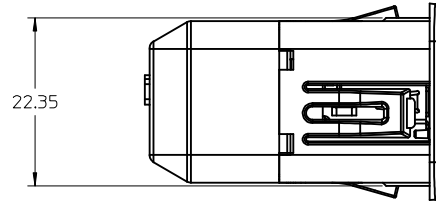
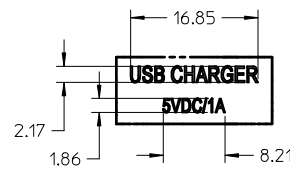

DETAIL 1
Scale 2:1

PIN-OUT	
PIN	SIGNAL
1	GND
2	BATTERY +
3	BACKLIGHT
4	---
5	---

NOTES:

- ASSEMBLY ACCORDING TO IPC-A-600 CLASS 2.
- PRINTED GRAPHICS AND TEXT COLOR WHITE
- DETAIL 1 TEXT TO BE ARIAL NARROW.
- COSMETIC SURFACE FINISHING ACCORDING TO MT11010.
- HOUSING MATERIAL: PC+ABS, COLOR BLACK
- INPUT: 9VDC - 16VDC
- OUTPUT 5VDC ±5% 1.0 AMP MAXIMUM
- USE MOLEX P/N 0436450500 FOR INPUT CONNECTOR.
- SEE MOLEX PS-79540-5002 FOR PERFORMANCE DETAILS.

LABEL DETAILS



*: 5 OR 6 (SEE CHART)
X: REVISION LEVEL
Y: YEAR
DDD: DAY OF THE YEAR
SSSS: CONSECUTIVE NUMBER

REV	DESCRIPTION	QUALITY SYMBOLS	GENERAL TOLERANCES (UNLESS SPECIFIED)		DIMENSION STYLE MM ONLY	SCALE 2:1	DESIGN UNITS METRIC	THIRD ANGLE PROJECTION
			mm	INCH				
2	REVISED	▽=0	4 PLACES ±	---	DRAWN BY LRUB10	DATE 2013/07/19	CCP SINGLE USB CHARGER WITH BACKLIGHT	
	EC NO: PCB2015-0052	▽=0	3 PLACES ±	---	CHECKED BY JSABATH	DATE 2013/07/19		
	IDRWINECANUL 2014/10/20	▽=0	2 PLACES ±	0.25	APPROVED BY JSABATH	DATE 2014/09/22		
	CHKD: JSABATH	▽=0	1 PLACE ±	---	MATERIAL NO.	DOCUMENT NO.		
	APPR: JSABATH 2014/10/20		0 PLACE ±	---	SEE CHART	SD-79540-5015		
			ANGULAR ±		SIZE	SHEET NO.		
			DRAFT WHERE APPLICABLE MUST REMAIN WITHIN DIMENSIONS		C	1 OF 1		
THIS DRAWING CONTAINS INFORMATION THAT IS PROPRIETARY TO MOLEX INCORPORATED AND SHOULD NOT BE USED WITHOUT WRITTEN PERMISSION								