

This document is the property of Amphenol Corporation and is delivered on the express condition that it is not to be disclosed, reproduced or used, in whole or in part, for manufacture or sale by anyone other than Amphenol Corporation without its prior consent, & that no right is granted to disclose or to use any information in this document.

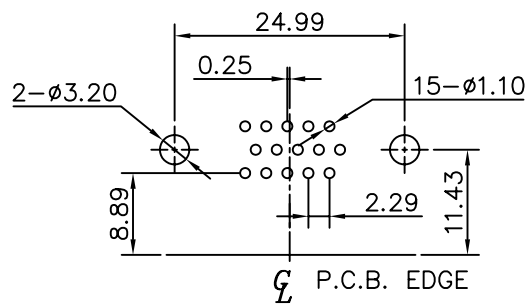
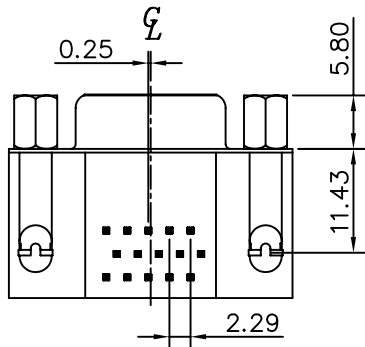
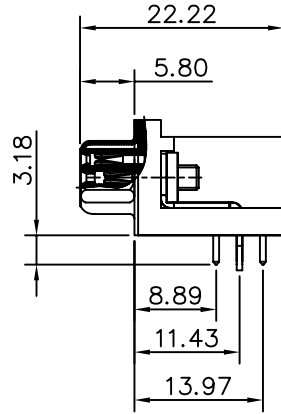
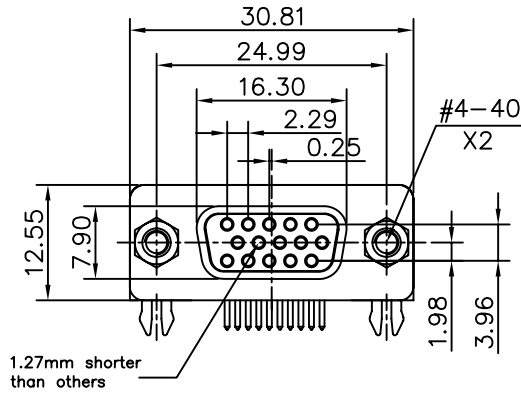

RECOMMENDED P.C.B LAYOUT
(TOLERANCE +/-0.03)

Customer drawing

REVISIONS				
SYM	ECN	DESCRIPTION	DATE	APPROVED
1			07/07/08	

D-SUB TECHNICAL DATA

SHELL : Steel, 2.5um(100u") min tin over 1.25um(50u") min nickel
 BODY : Nylon 9T UL 94V-0 Rated. Color: Blue
 CONTACTS : Brass
 Gold flash over 1.25um(50u") min nickel
 SCREWLOCK : Brass, 50u" min nickel
 C grade C grade material for screwlock, rivet
 BOARDLOCK : Brass,100u" min tin over 50u" min nickel
 ELECTRICAL : Voltage rating : 600 V RMS at 50Hz
 Current rating : 3A
 Insulation resistance >5000 M Ohms
 Contact resistance 20mOhms max.
 CLIMATIC : Temperature range -55 °C up to 150°C
 MARKING : No any marking on the connector

PRODUCT CODE

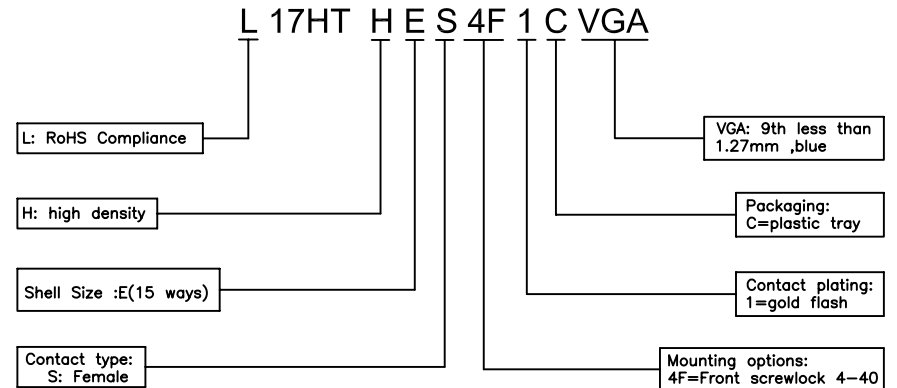

UNLESS OTHERWISE SPECIFIED TOLERANCES		APPROVAL		DATE
	U.S.	METRIC	DRAWING	Marg.ma 07/07/08
.X +/-	0.50		CHECKED	Wk.wang 07/07/08
.XX +/-	0.30		CHECKED	
.XXX +/-	0.20			
FRACTIONS +/-				
ANGLES +/-	5°			
FOR MATERIALS AND FINISHES SEE NOTES		DRAWING FILE :		
REMOVE SHARP EDGES		ANGLE OF PROJECTION		
DIMENSIONS				
U.S.	INCHES			
METRIC	MM			

Amphenol®		
TITLE D-SUB contacts, HTH series		
SIZE	DRAWING NO.	REV.
A4	C L17HTHES4F1CVGA	1
SCALE	NONE	SHEET 1 OF 1