

PLEASE CHECK WWW.MOLEX.COM FOR LATEST PART INFORMATION

Part Number: [62201-8634](#)
Status: **Active**
Description: Support Tool for Vertical Power Module for 11-Row Receptacle

Documents:
[RoHS Certificate of Compliance \(PDF\)](#)

General

| | |
|--------------------------------|--|
| Product Family | Application Tooling |
| Series | T3002 |
| Comments | See Tooling Specification (PDF) Above |
| Function | Insertion |
| Geographic Area | Global |
| Level of Automation | Manual |
| More Detailed Tech Information | applicationtooling@molex.com |
| Product Name | N/A |
| Survey | www.molex.com//review/apptool_survey.html |
| Tool Type | Handtool |
| UPC | 800756697758 |

Material Info

Reference - Drawing Numbers

Application Tooling Documents ATS-622018634, TM-622018699, TM-622022099

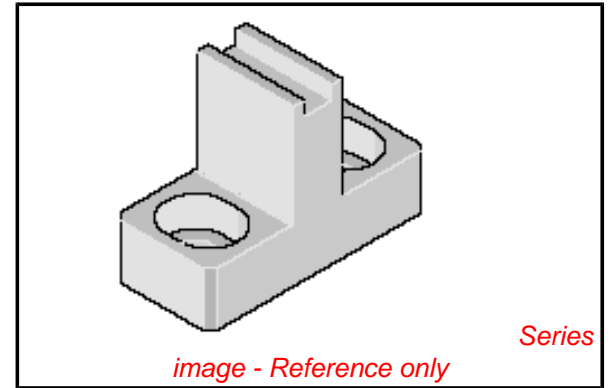

image - Reference only

EU RoHS **China RoHS**

Compliance Status

Not Reviewed

REACH SVHC

Not Reviewed

Low-Halogen Status

Not Reviewed

Need more information on product environmental compliance?

Email productcompliance@molex.com
 For a multiple part number RoHS Certificate of Compliance, [click here](#)

Please visit the [Contact Us](#) section for any non-product compliance questions.

Search Parts in this Series

[T3002Series](#)

Use With

GbX I-Trac™ Vertical Power Module, [78232](#)

Application Tooling | **FAQ**
Description | **Product #**

| | |
|----------------------|------------|
| GbX I-Trac™ Vertical | 0782321001 |
| Receptacle, Power | |
| Module, 2 Blades, 80 | |
| Amps, Lead-Free | |
| GbX I-Trac™ Vertical | 0782325001 |
| Receptacle, Power | |
| Module, 2 Blades, 80 | |
| Amps | |