

REV.	DATE	DESCRIPTION
A	11/19/03	UPDATE DRAWING FORMAT

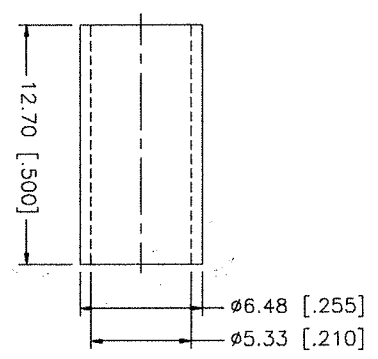
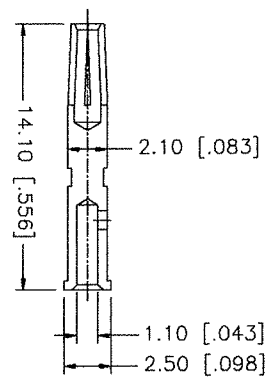
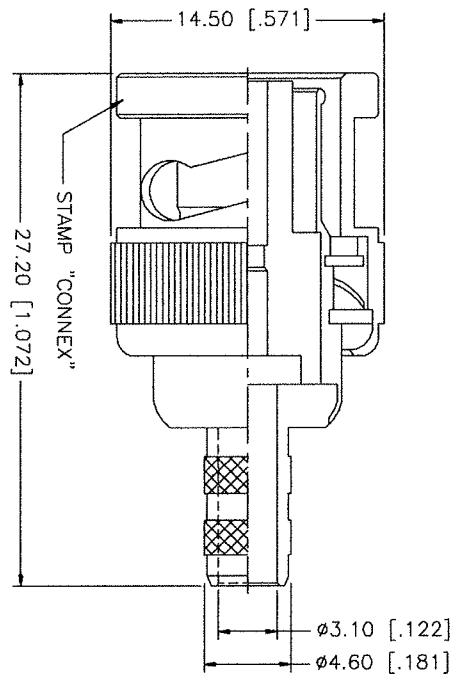
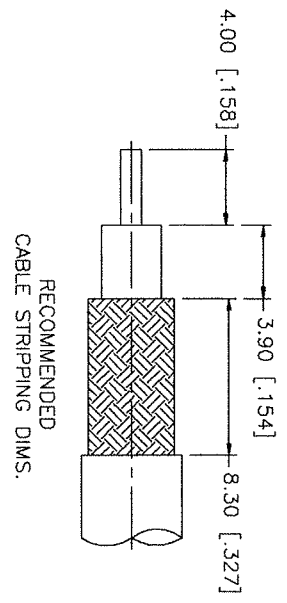

NOTE:
 1. CRIMPED FERRULE
 HEX CRIMP SIZE .213"
 2. CRIMPED CONTACT PIN
 HEX CRIMP SIZE .068"

DESCRIPTION	MATERIAL	FINISH	QTY	DO NOT SCALE DRAWING	APPROVALS	DATE	PART DESCRIPTION	PART NO.	DWG. NO.	REV.	SIZE	SCALE
8							<h1 style="text-align: center;">Amphenol Connex</h1> <p style="text-align: center;">BNC REVERSE POLARITY CRIMP PLUG (FOR RG-58C/U CABLE)</p> <p style="text-align: center;">112116RP</p>		112116RP.DWG	A	A	NA
7												
6												
5	FERRULE	COPPER	NICKEL	1	CHECKED	11/19/03						
4	CONTACT PIN	PHOS. BRONZE	GOLD	1	ISSUED							
3	INSULATOR	TEFLON	NATURAL	1	SHEET	1 OF 1						
2	BODY	BRASS	NICKEL	1								
1												

UNLESS OTHERWISE SPECIFIED DIMENSIONS ARE IN MILLIMETERS. DIMENSIONS IN [] ARE IN INCHES AND FOR CUSTOMER REFERENCE ONLY.
 TOLERANCES FOR MILLIMETERS ARE:
 0.5 - 8mm ± 0.20mm
 8 - 30mm ± 0.40mm
 30 - 120mm ± 0.50mm
 UNLESS OTHERWISE SPECIFIED DIMENSIONS FOR INCHES ARE:
 .020 - .315 = ± 0.007"
 .315 - 1.180 = ± 0.015"
 1.180 - 4.724 = ± 0.020"

DO NOT SCALE DRAWING	APPROVALS	DATE
	G.R.S.	11/19/03

DESCRIPTION	MATERIAL	FINISH	QTY	DO NOT SCALE DRAWING	APPROVALS	DATE	PART DESCRIPTION	PART NO.	DWG. NO.	REV.	SIZE	SCALE
8							<h1 style="text-align: center;">Amphenol Connex</h1> <p style="text-align: center;">BNC REVERSE POLARITY CRIMP PLUG (FOR RG-58C/U CABLE)</p> <p style="text-align: center;">112116RP</p>		112116RP.DWG	A	A	NA
7												
6												
5	FERRULE	COPPER	NICKEL	1	CHECKED	11/19/03						
4	CONTACT PIN	PHOS. BRONZE	GOLD	1	ISSUED							
3	INSULATOR	TEFLON	NATURAL	1	SHEET	1 OF 1						
2	BODY	BRASS	NICKEL	1								
1												