



Series F40 Thru-Hole .040 [1.02] Female DIP Strips

FEATURES:

- This female DIP strip is used in conjunction with Aries' Shorting Plug SP200, available separately, for your programming needs.
- "Break" feature allows strips to be cut to the number of positions desired.

SPECIFICATIONS:

- Body material is black UL 94V-0 Glass-filled 4/6 Nylon.
- Pin body is Brass Alloy 360 1/2 hard per UNS C36000 ASTM-B16-00.
- Pin body plating:
 - 10 = 200µ [5.08µm] min. Tin per ASTM B545 Type 1 over 100µ [2.54µm] min. Nickel per SAE-AMS-QQ-N-290.
 - 10TL = 200µ [5.08µm] min. 93/7 Tin/Lead per MIL-P-81728 over 100µ [2.54µm] min. Nickel per SAE-AMS-QQ-N-290.
- 4-fingered collet contact is Beryllium Copper Alloy per UNS C17200 ASTM-B194-01.
- Collet contact plating is 30µ [7.6µm] min. Gold per MIL-G-45204 over 50µ [1.27µm] min. Nickel per SAE-AMS-QQ-N-290.
- Contact current rating=8 Amps.
- Operating temperature= -67° to 221°F [-55° to 105°C].
- Insertion Force=240 grams/pin; Withdrawal Force=130 grams/pin; Normal Force=210 grams/pin; based on a .040 [1.02] diameter test lead.
- Accepts leads .032-.047 [.81-1.19] in diameter, .130-.180 [3.30-4.56] long.

MOUNTING CONSIDERATIONS:

- Suggested PCB hole size=.081 ± .002 [2.03 ± .05] dia.

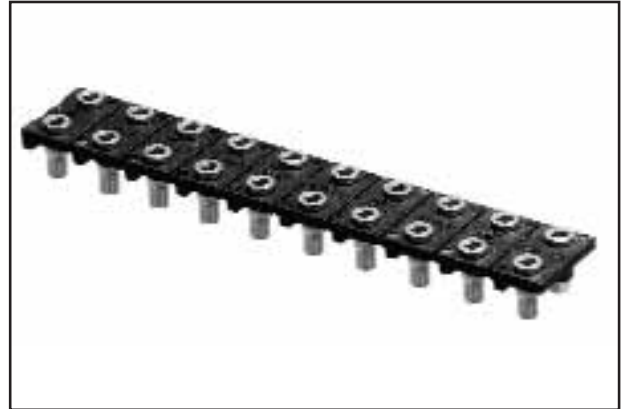

Note: Aries specializes in custom design and production. In addition to the standard products shown on this page, special materials, platings, sizes, and configurations can be furnished, depending on quantities. Aries reserves the right to change product specifications without notice.

ORDERING INFORMATION

XX - F40 - 10 XX

No. of Pins: | Series | Plating Option:
 2 - 20 (even # only) | F40 | TL = Tin/Lead
 Ex. 02 = 2 pins | |
 14 = 14 pins | | Tin Plating

ALL DIMENSIONS: INCHES [MILLIMETERS]

All tolerances ± .005 [.13] unless otherwise specified

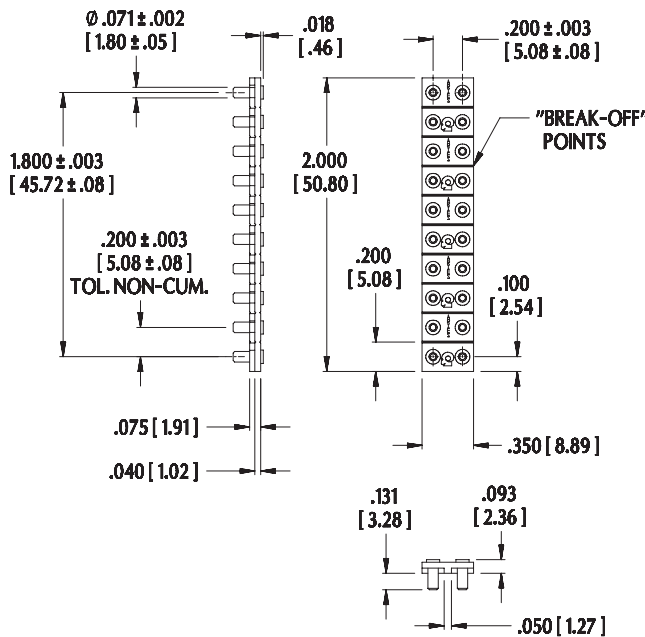

CONTACT DETAIL

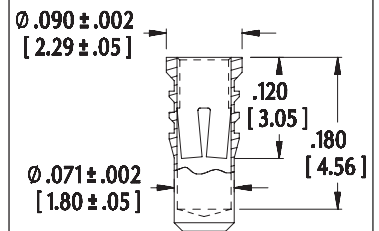

Consult Data Sheet No. 16007 for thru-hole male DIP strips.

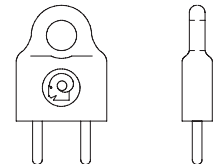

Mates with Aries' Shorting Plugs, Part No. SP200. Consult Data Sheet No. 16009 for details.



Bristol, PA 19007-6810 USA
 TEL (215) 781-9956 • FAX (215) 781-9845
 WWW.ARIESELEC.COM • INFO@ARIESELEC.COM



16008
REV. E