

THIS COPY IS PROVIDED ON A RESTRICTED BASIS AND IS NOT TO BE USED IN ANY WAY DETRIMENTAL TO THE INTERESTS OF PANDUIT CORP.

PART#	COLOR	DESCRIPTION	WEIGHT*
CJS5E88TGY	BLACK	8 POSITION, 8 WIRE SHIELDED MODULE WITH INTEGRAL SHIELD. WIRE CAP LABEL IS COLOR CODED FOR T568A AND T568B WIRING SCHEMES.	3.715 LB/100 PCS (1685g/100 PCS)
CJS5E88TGRDY	RED		
CJS5E88TGBUY	BLUE		
CJS5E88TGGRY	GREEN		
CJS5E88TGVLY	VIOLET		
CJS5E88TGWHY	WHITE		
CJS5E88TGYLY	YELLOW		

*WEIGHT IS APPROXIMATE

NOTES:

1. RED WIRE CAP DESIGNATES CATEGORY 5E PERFORMANCE.
2. MATERIAL:
MODULE HOUSING-ABS
SHIELD-TIN PLATED OVER PHOS. BRONZE
WIRE CAP/CLIP - ZINC AND PC
3. ALL TX5e,6 AND 6A 8 POSITION, 8 WIRE JACK MODULES ARE UNIVERSAL IN DESIGN. THEY ACCEPT SIX AND EIGHT POSITION MODULAR PLUGS WITHOUT DAMAGE.
4. DIMENSIONS IN PARENTHESES ARE IN METRIC.
5. .187 x .010" GROUNDING TAB PROVIDED AS OPTIONAL CONDUCTIVE PATH FOR GROUNDING.

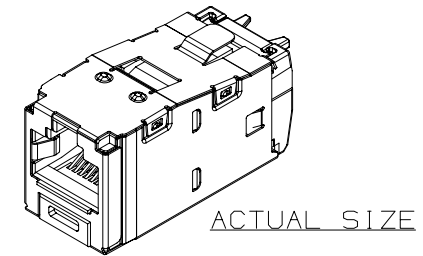
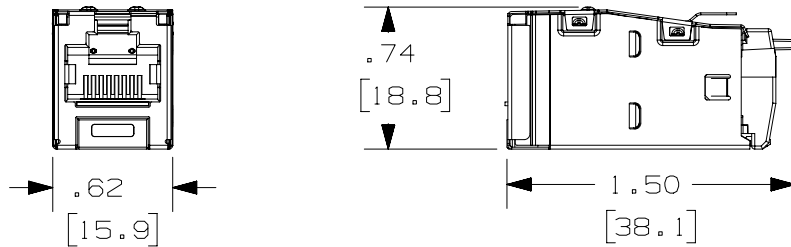
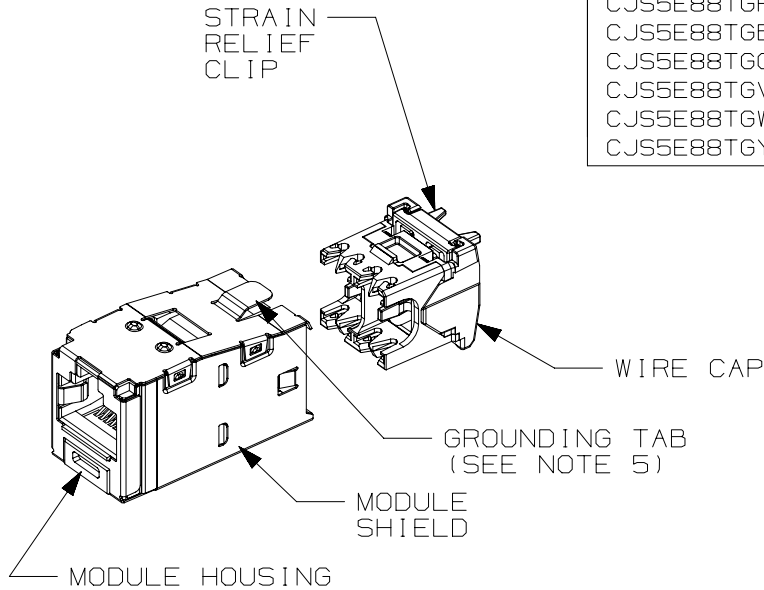

PART NUMBER		CJS5E88TG**Y	
TITLE		TX5E SHIELDED JACK MODULE	
		CUSTOMER DRAWING	
ITEM REVISION NAME		M02479NR/06	PANDUIT
DATASET FILE NAME		M02479NR_DC356/06C	
UNLESS OTHERWISE SPECIFIED, DIMENSIONAL TOLERANCES ARE: IN [mm]		MATERIAL: SEE NOTE 2	
.x ± .xx ± .03 (.8)		.xxx ± .010 (.3)	
ANGLES ±		DRAWING NUMBER: 02479-356	
THIRD ANGLE PROJECTION		SHT 1 OF 1	
DRAWN BY	DATE	CHK	SCALE
AFW	3-11-06	CEF	FULL
REV	DATE	BY	CHK
8	4-26-18	BJN	BSN
7	4-12-18	BJN	MDJR
6	2-15-17	ROJC	NAGL
APR	DESCRIPTION		ECN

REV	DATE	BY	CHK	APR	DESCRIPTION	ECN
8	4-26-18	BJN	BSN	TMBA	UPDATED WEIGHT ALIGNED METRIC DIMENSIONAL EQUIVALENTS	02479-356
7	4-12-18	BJN	MDJR	TMBA	ADDED WHITE TO COLOR OPTIONS	02479-356
6	2-15-17	ROJC	NAGL	TMBA	MODEL REVISION UPDATED REMOVED PREVIOUS REVISIONS FOR CLARITY	02479-356

D10100DA/14