

- NOTES:**
1. MATERIAL: COPPER ALLOY
  2. PLATING:
    - ITEM 1: 30µin HARD GOLD over min. 50µin NICKEL
    - ITEM 2: GOLD FLASH over NICKEL
    - ITEM 3: NICKEL PLATED
  3. CRIMPING: USE CRIMP TOOL 360X10409X  
WITH TOOL INSERT 360X20029X  
SELECTOR SETTINGS: 3 FOR AWG 16  
2 FOR AWG 18  
2 FOR AWG 20

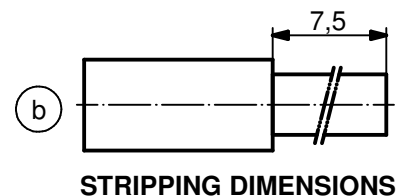

Directive 2002/95/EC RoHS compliant

THIS DRAWING MAY NOT BE COPIED OR REPRODUCED IN ANY WAY, AND MAY NOT BE PASSED ON TO A THIRD PARTY WITHOUT WRITTEN PERMISSION. OWNERSHIP AND COPYRIGHT OF CONEC GmbH

DO NOT ALTER CAD DRAWING BY HAND

finish: SEE NOTES				tolerance ISO 2768-m		dim. in mm	
				date	name		
				drawn	23.03.98	Barcinski	
				appd.	23.03.98	Mickenbecker	
				norm			
				d-old			
3 x b	Ä3854	19.01.2011	K.H.	<b>CONEC</b> ®			
a	Origin						
rev.	description	date	name				

b

scale:		5:1	
material:		SEE NOTES	
title: High Power Contact male Crimp version 10A Hochstromkontaktstift			
dwg no:		Inventor 10	DIN-A4
		sh: 1	
part no:		131C11019X	