

PART NUMBER	REV	FIRST USED
687765	E	122500
687765-2	F	565435-5
687765-3	F	354500-1

OBSOLETE

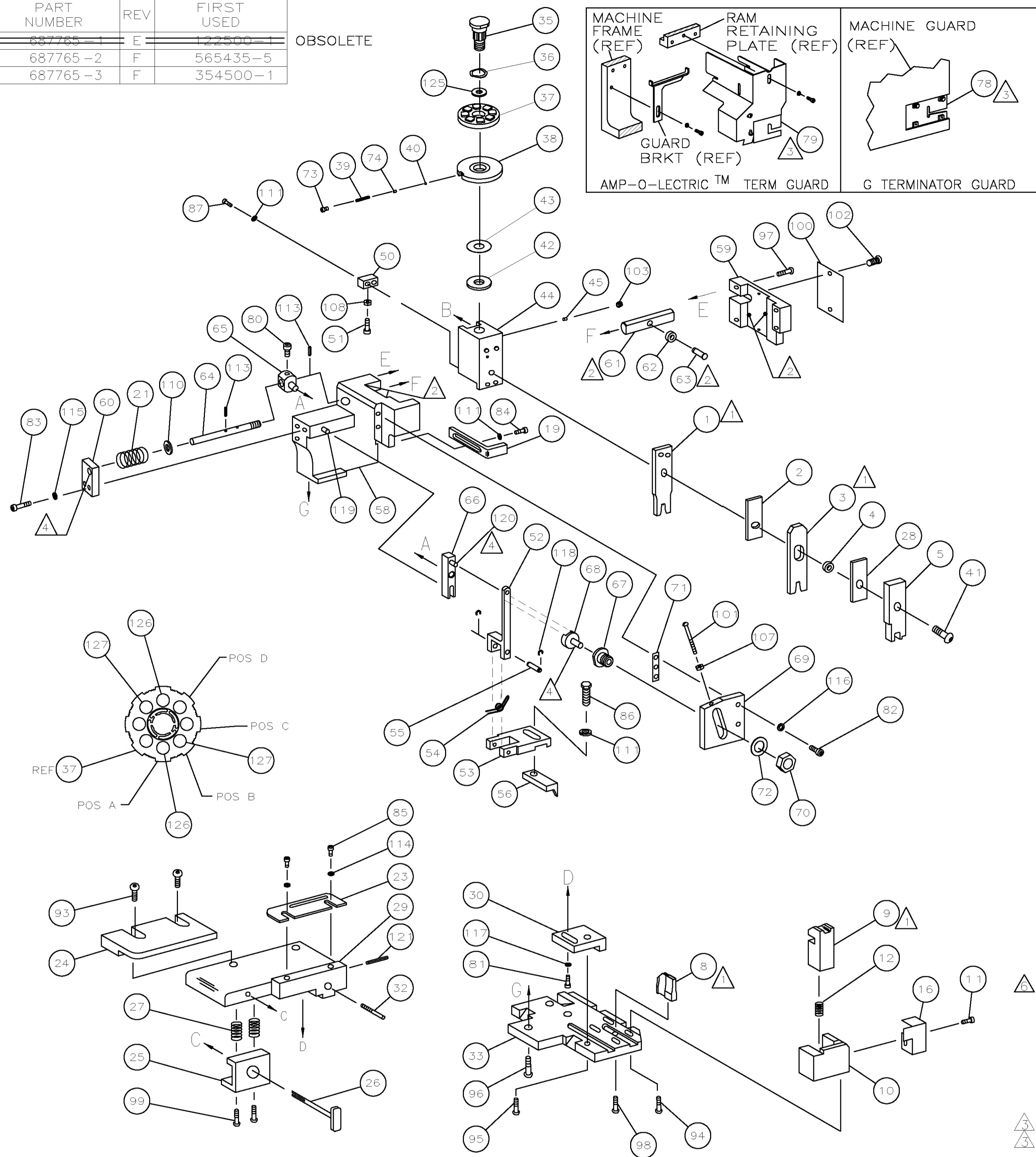
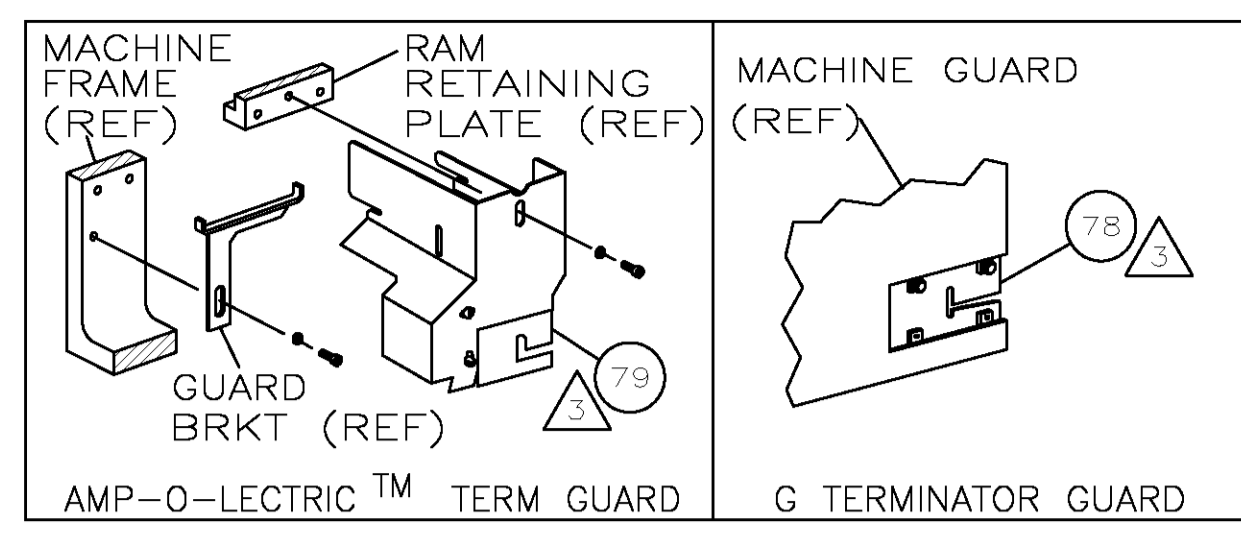

TERMINAL NAME: MATE-N-LOK™ TERMINAL		CRIMPING DATA			
WIRE STRIP LENGTH	TERM APPL SPEC	FEED	APPL INSTRUCTION	SET UP GAGE	LAYOUT
.660 FEED	61233				
.500 FEED	61234				
.660 FEED	1586486				
		PAD LTR	CRIMP HEIGHT	WIRE SIZE	
		A	.106 ±.002 [2.69 ±.05mm]	10	
		B	.087 ±.002 [2.21 ±.05mm]	12	
		C	NOT	USED	
		D	NOT	USED	
		CRIMP	SIZE	TYPE	RANGE
		WIRE	.140 [3.56mm]	F	12-10
		INSUL	.210 [5.33mm]	F	.185 MAX
.175-.205	114-1109	.500&.660	408-8040	458637-1	223-HD

QTY	RECD	PER	ASSY	PARTS LIST			
				129			
				128			
2	2	2	-	C 6-354778-5 PIN, WIRE DISC (.2820)B	127		
2	2	2	-	C 2-354778-2 PIN, WIRE DISC (.2605)A	126		
1	1	1	-	A 986950-1 WASHER, FLAT PRECISION	125		
1	1	1	-	A 217238-1 GENERAL INSTRUCTION PACKAGE	124		
1	1	1	-	- 4088040 SF APPL INST 408-8040	123		
					122		
1	1	1	-	A 4-21028-0 PIN,SLT SPR(Ø.093x.75)ST GDE PL	121		
REF	REF	REF	-	A 1-21030-1 PIN,DOWEL(Ø.187x.50)LEVER	120		
REF	REF	REF	-	A 1-21030-6 PIN,DOWEL(Ø.187x1.25)HOUSING	119		
REF	REF	REF	-	A 21045-3 RING,RET "C"(Ø.187)FD FING PIN	118		
1	1	1	-	A 21024-5 WASHER, LOCK(#10)ADJ BLOCK	117		
REF	REF	REF	-	A 21024-5 WASHER,LOCK(#10)ADJ PLATE	116		
REF	REF	REF	-	A 21024-5 WASHER,LOCK(#10)FEED GDE ROD	115		
2	2	2	-	A 21024-2 WASHER,LOCK(#4)FRONT STP GUIDE	114		
REF	REF	REF	-	A 5-21028-1 PIN,SLT SPR(Ø.125x.50)ADJ ROD	113		
					112		
4	4	4	-	A 21024-4 WASHER,LOCK(#8)STRIPPER	111		
REF	REF	REF	-	A 21899-4 WASHER,FLAT(Ø5/16)SCREW ADJ	110		
					109		
1	1	1	-	A 21018-5 NUT,HEX(NO.6)HOLDDOWN	108		
REF	REF	REF	-	A 21018-5 NUT,HEX(6-32)FEED ADJ	107		
					106		
					105		
					104		
1	1	1	-	A 21009-2 SCR,SKT SET(1/4-20x.25 LW)RAM	103		
2	2	2	-	A 21017-2 SCR,DRIVE(#2x.19)ID PLATE	102		
REF	REF	REF	-	A 6-23715-5 SCR,PAN HD(6-32x1.50)FEED ADJ	101		
1	1	1	-	B 461264-1 PLATE, IDENTIFICATION	100		
2	2	2	-	A 3-21002-0 SCR,BHC(10-32x.88)DRAG	99		
1	1	1	-	A 22733-8 SCR,BHC(8-32x.38 LW)ANVIL	98		
REF	REF	REF	-	A 2-21002-9 SCR,BHC(10-32x.75)CAP	97		
REF	REF	REF	-	A 2-22733-8 SCR,BHC(1/4-20x.62)HOUSING	96		
REF	REF	REF	-	A 2-21002-7 SCR,BHC(10-32x.50)SG ADJ BLOCK	95		
2	2	2	-	A 2-21002-2 SCR,BHC(8-32x.50)TERM H DWN	94		
2	2	2	-	A 2-21002-3 SCR,BHC(8-32x.62)R STP GDE	93		
					92		
1	1	1	-	A 1-21002-7 SCR,BHC(6-32x.38)CAM	91		
					90		
					89		
					88		
2	2	2	-	A 2-21000-7 SCR,SHC(8-32x.48)DEP-HOLD	87		
1	1	1	-	A 2-22603-0 SCR,HEX HD(8-32x.31)FEED FINGER	86		
2	2	2	-	A 1-21000-3 SCR,SHC(4-40x.25)F ST GUIDE	85		
1	1	1	-	A 2-21000-7 SCR,SHC(8-32x.50)STRIPPER	84		
REF	REF	REF	-	A 3-21000-7 SCR,SHC(10-32x.75)FEED ROD GD	83		
REF	REF	REF	-	A 3-21000-6 SCR,SHC(10-32x.62)FD ADJ BLK	82		
1	1	1	-	A 3-21000-4 SCR,SHC(10-32x.38)SG ADJ BL	81		
REF	REF	REF	-	A 3-21000-4 SCR,SHC(10-32x.38)PIVOT BLK	80		
-	REF	-	-	B 455749-1 GUARD, WINDOW	79		
REF	-	-	-	B 679532-1 INSERT, GUARD	78		
					77		
					76		
					75		
1	1	1	-	A 690603-1 SPRING, ASSIST	74		
1	1	1	-	A 23030-1 SCR,SHC(6-32x.25 SL)INS DISC	73		
REF	REF	REF	-	A 458109-1 WASHER, SPECIAL	72		
REF	REF	REF	-	A 690517-1 SPACER	71		
-3	-2	-1	U/M	DWG SIZE	PART NO	DESCRIPTION	ITEM NO
QTY REOD PER ASSY				PARTS LIST			

QTY	RECD	PER	ASSY	PARTS LIST			
				129			
				128			
1	1	1	-	B 458537-2 PAWL, FEED	56		
REF	REF	REF	-	B 240624-1 PIN, FEED FINGER	55		
REF	REF	REF	-	B 691499-1 SPRING, FEED FINGER	54		
REF	REF	REF	-	B 690541-1 HOLDER, FEED FINGER	53		
REF	REF	REF	-	A 455679-2 LEVER, TERMINAL FEED ARM	52		
1	1	1	-	A 811242-2 BUMPER, HOLDDOWN	51		
1	1	1	-	A 690753-1 SPACER, TONKER	50		
1	-	-	-	B 690602-6 CAM, PRE-FEED 1 5/8 ST	49		
-	1	1	-	B 690602-5 CAM, PRE-FEED 1 1/8 ST	48		
-	-	-	-	B 690501-4 CAM, POST-FEED 1 5/8 ST	47		
1	1	1	-	B 459456-2 APPLICATOR, BASIC (SUBASSY)	46		
1	1	1	-	A 690191-1 PLUG, NYLON	45		
1	1	1	-	C 455673-1 RAM	44		
1	1	1	-	A 690125-1 WASHER, LAMINATED	43		
1	1	1	-	A 690124-1 WASHER, RAM	42		
1	1	1	-	A 7-21002-9 BOLT, CRIMPER(5/16x1.00)	41		
1	1	1	-	A 23241-6 BALL, STEEL	40		
1	1	1	-	A 690170-1 SPRING, COMPRESSION	39		
1	1	1	-	C 690142-1 DISC, INSULATION	38		
1	1	1	-	D 354777-1 WIRE DISC, PLASTIC	37		
1	1	1	-	A 22480-5 WASHER, SPRING	36		
1	1	1	-	B 690212-1 POST, RAM	35		
					34		
REF	REF	REF	-	D 455675-1 PLATE, BASE	33		
1	1	1	-	A 690432-3 SCREW, ADJUSTMENT	32		
					31		
REF	REF	REF	-	B 455689-1 BLOCK, STRIP GUIDE ADJ	30		
1	1	1	-	C 455671-2 PLATE, STRIP GUIDE	29		
1	1	1	-	C 1-455888-7 SPACER, FRONT SHEAR DEP	28		
2	2	2	-	A 1-22284-0 SPRING, DRAG	27		
1	1	1	-	B 690546-1 LEVER, DRAG RELEASE	26		
1	1	1	-	B 240792-1 DRAG, TERMINAL	25		
1	1	1	-	D 1-690504-0 GUIDE, STRIP (REAR)	24		
1	1	1	-	A 690438-1 GUIDE, STRIP (FRONT)	23		
					22		
REF	REF	REF	-	A 4-22284-9 SPRING, FEED RETURN	21		
					20		
1	1	1	-	B 690472-1 STRIPPER	19		
					18		
					17		
1	1	1	-	B 318563-1 GUARD, CHIP, FRONT	16		
					15		
					14		
					13		
1	1	1	-	A 5-22280-0 SPRING, SHEAR	12		
1	1	1	-	B 690461-1 STOP, SHEAR	11		
1	1	1	-	C 690459-1 HOLDER, SHEAR (FRONT)	10		
1	1	1	-	C 690491-2 SHEAR, FLOAT (FRONT)	9		
1	1	1	-	C 9-690471-4 ANVIL	8		
					7		
					6		
1	1	1	-	C 458157-2 DEPRESSOR, SHEAR (FRONT)	5		
1	1	1	-	B 1-238011-0 SPACER, BLOCK CRIMPER	4		
1	1	1	-	C 3-456134-1 CRIMPER, INSULATION	3		
1	1	1	-	C 455888-7 SPACER, CRIMPER	2		
1	1	1	-	C 456411-7 CRIMPER, WIRE	1		
-3	-2	-1	U/M	DWG SIZE	PART NO	DESCRIPTION	ITEM NO
QTY REOD PER ASSY				PARTS LIST			

POST FEED 1 5/8 STROKE	PRE FEED 1 1/8 STROKE	PRE FEED 1 5/8 STROKE
LEADMAKER	K TERMINATOR	G TERMINATOR

1 RECOMMENDED SPARE PARTS.  
 2 GREASE LIGHTLY.  
 3 GUARD MUST BE IN PLACE WHEN OPERATING APPLICATOR IN A BENCH MACHINE.  
 4 LUBRICATE DAILY USING NO. 20 MACHINE OIL.  
 5. ITEMS WITH QTY OF REF SPECIFIED (EXCEPT ITEMS 78 AND 79) ARE USED ON ITEM 46.  
 6 CUT TO LENGTH AT ASSY