

THIS COPY IS PROVIDED ON A RESTRICTED BASIS AND IS NOT TO BE USED IN ANY WAY DETRIMENTAL TO THE INTERESTS OF PANDUIT CORP.

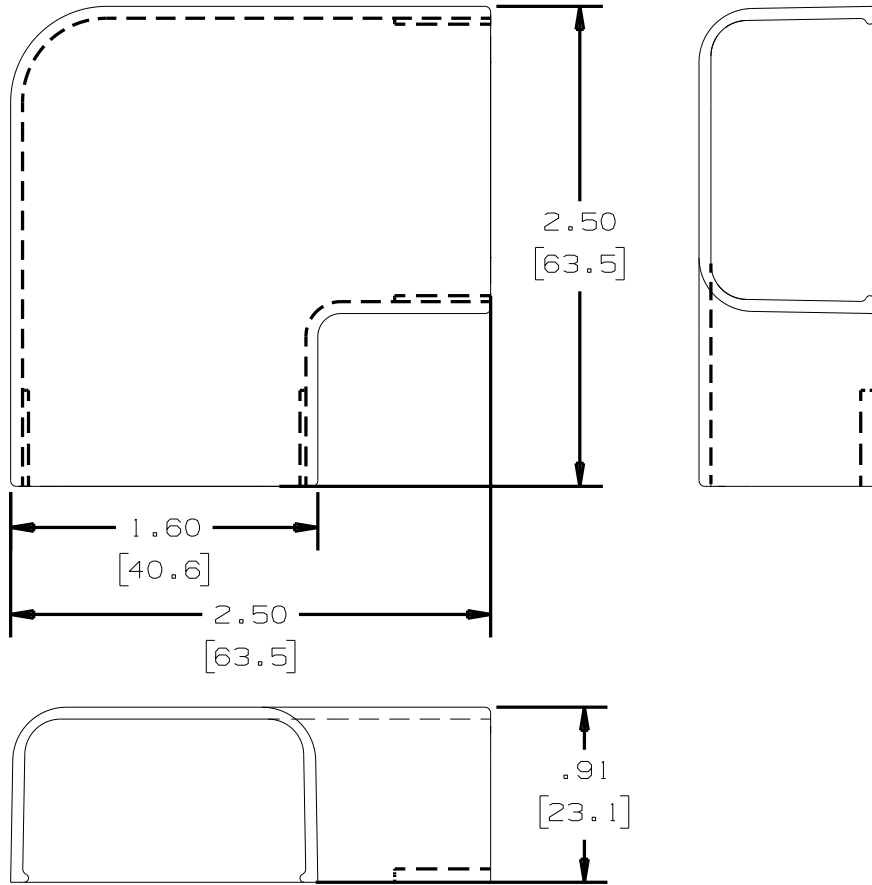

PANDUIT P/N	WEIGHT
RAF10	.03 LB/ EACH [13 g/ EACH]



NOTES:

1. SEE CURRENT CATALOG FOR ADDITIONAL PART SUFFIXES TO INDICATE COLOR AND OR PACKAGE QUANTITY.
2. DIMENSIONS IN PARENTHESIS ARE IN METRIC.

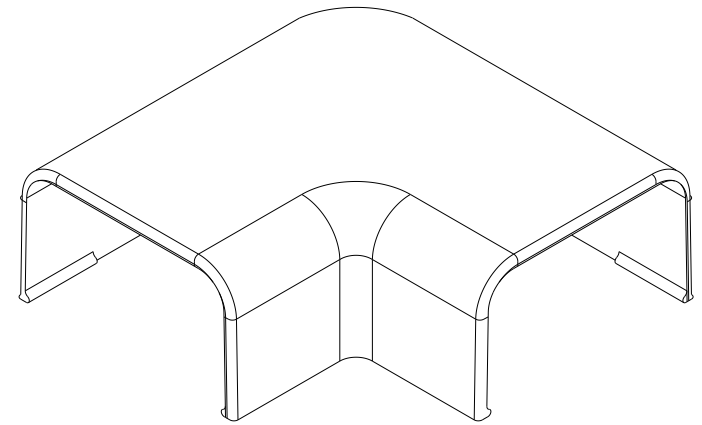

REV	DATE	BY	CHK	DESCRIPTION	ECN	R	CUST	SUP
--	--	--	RELEASED TO PRODUCTION	--	--	
8	06-11-08	BDK	RMH	I. REVISED TO CURRENT CAD STANDARDS DRAWING NUMBER WAS SS-1776	1776		RTFI	RTFI
7	7-3-02	JHNU	RMH	H. REVISED MATERIAL IN DRAWING TITLE BLOCK.	1776		RGRO	RGRO
6	5-18-01	REWE	BKR	G. REVISED WEIGHT QUANTITY F. REVISED TITLE: WAS REDUCER FITTING	1776		BKR	HIW
5	8-30-00	JHNU	HIW	E. REVISED AND REDRAWN.	1776		HIW	HIW
4	9-30-91	DW	CF	D. REV'D NOTE AND REMOVED COLOR FROM DWG.	1776		CF	CF
3	2-28-91	DW	CF	C. REV'D COLORS: OMIT BLACK, BEIGE, LIGHT IVORY, AND LIGHT GREY. ADDED INT. WHITE AND INT. GREY.	1776		CF	WJB/CF
2	12-2-87	LDB	WJB	B. ADDED P/N RAF10EI AND RAF10LI.	1776		WJB	WJB
1	10-1-84	CEK	HMP	A. REVISED MAT'L.	1776		HMP	AJC
R	11-2-82	SS	HMP	DRAWING RELEASED	1776		HMP	JKR

CAD FILENAME/LAYERS D34116BB_DC_RAF10_01D.PRT

PANDUIT CORP. TINLEY PARK, ILLINOIS

RIGHT ANGLE FITTING (RAF10)
CUSTOMER DRAWING



UNLESS OTHERWISE SPECIFIED,
DIMENSIONAL TOLERANCES ARE:
(.X) ± (.XXX) ±
(.XX) ± .031(.8) ANGLES ±

UNLESS OTHERWISE SPECIFIED,
ALL DIMENSIONS ARE GIVEN
IN INCHES, THIRD ANGLE PROJECTION.

DRAWN BY
SARGIS

MAT'L:

SCALE FULL

DATE
11-2-82

ABS

DRAWING NO. 34116-12

CHK'D
JVL



DWG
A
SIZE