

87760

PART NUMBER	CKT SIZE	A	B
87760-4050	40	38.00	40.00

NOTES:

- MATERIAL:
HSG: PCT, 30% GLASS FILLED, UL 94V-0 COLOUR BLACK.
PIN: 0.50MM SQ. PHOSPHOR BRONZE 510
- PLATING:
0.38um MIN GOLD IN CONTACT AREA, TIN IN SOLDERTAIL AREA, BOTH OVER NICKEL OVERALL
- PARTS TO BE PACKED IN TRAY.
- PRODUCT SPEC PS-87761-100 APPLIES.
- RECOMMENDED PCB BOARD THK 1.60±0.10 MM.

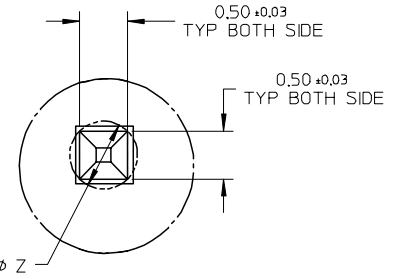
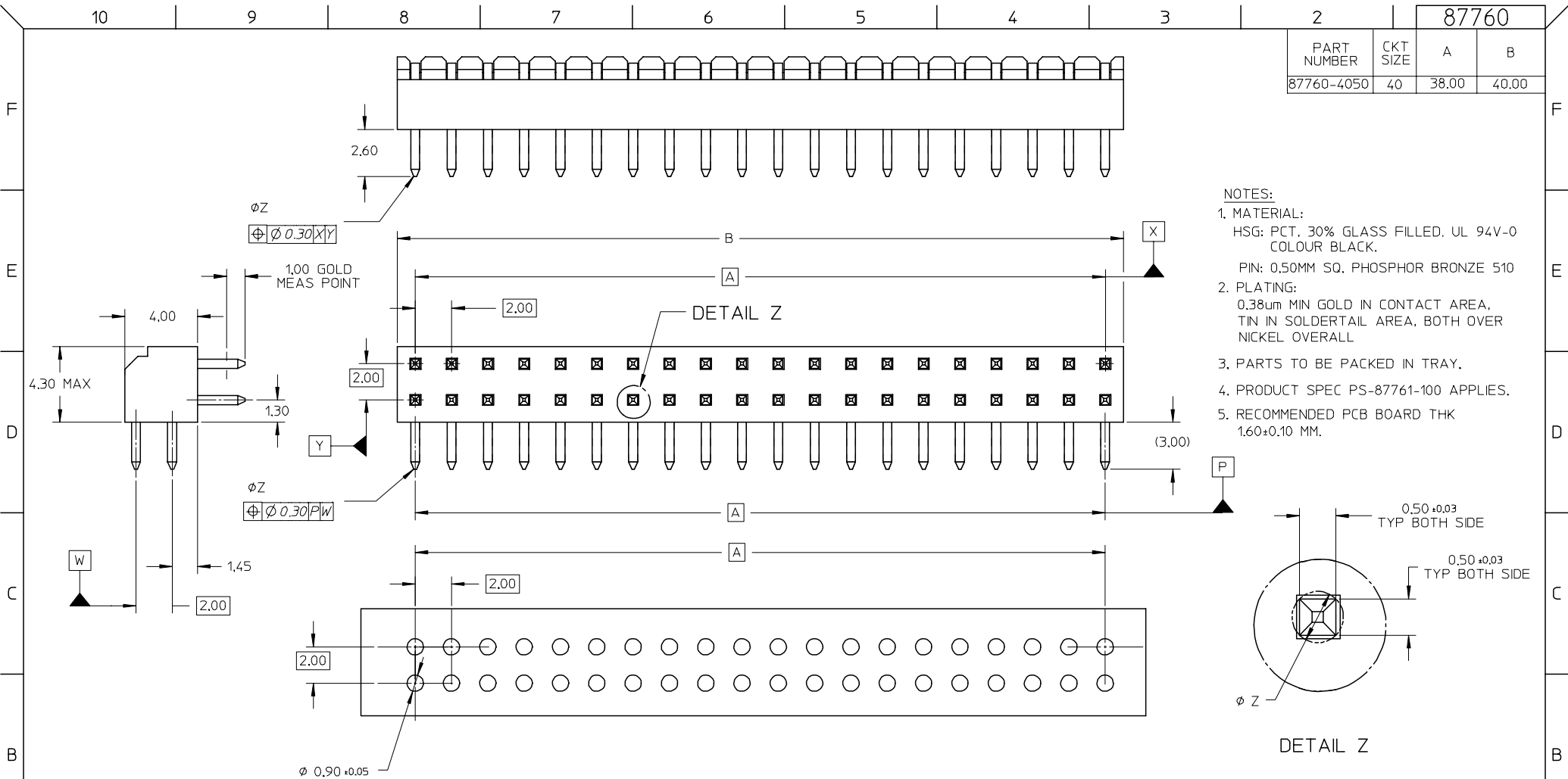

DETAIL Z

EC NO: S2004-088Z DRW/KSEE 2004/09/28 CHKD:PTLM 2004/09/28 APPR:SKTOH 2004/09/28	QUALITY SYMBOLS ▽ = 0 ▽ = 0	GENERAL TOLERANCES (UNLESS SPECIFIED)		SCALE NTS	DESIGN UNITS METRIC	THIRD ANGLE PROJECTION	REVISE ON CAD ONLY
		4 PLACES ± --- ± --- 3 PLACES ± --- ± --- 2 PLACES ± 0.2 ± --- 1 PLACE ± --- ± ---	DIMENSION STYLE MM ONLY	TITLE SALES DRAWING MGRID, 2MM DUAL ROW HDR. R/A			
		ANGULAR ± 3 °	DRAWN BY KSEE	DATE 2003/10/16	MOLEX MOLEX INCORPORATED		
		DRAFT WHERE APPLICABLE MUST REMAIN WITHIN DIMENSIONS	CHECKED BY KCLING	DATE 2003/12/02	MATERIAL NO. SEE TABLE	DOCUMENT NO. SD-87760-118	SHEET NO. 1 OF 1
A1	REV	THIS DRAWING CONTAINS INFORMATION THAT IS PROPRIETARY TO MOLEX INCORPORATED AND SHOULD NOT BE USED WITHOUT WRITTEN PERMISSION				B	