

PRODUCT NUMBER	PITCH
VKxx12x000J0G	3.50 mm

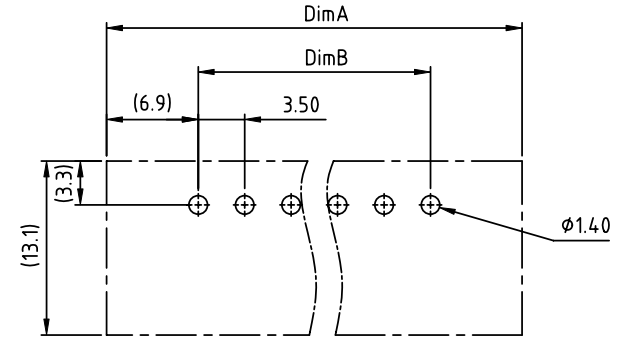

RECOMMENDED P.C.B. LAYOUT  
TOP VIEW

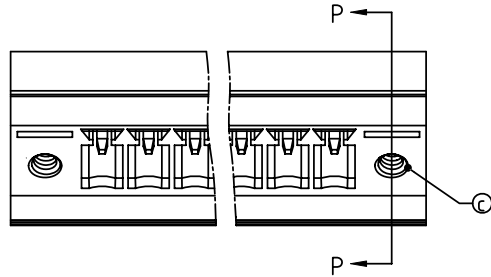
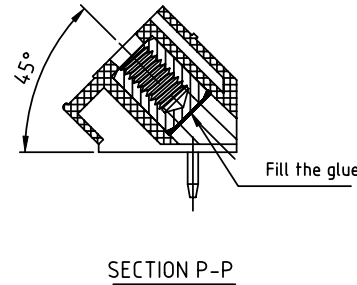
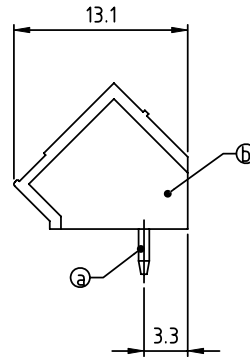
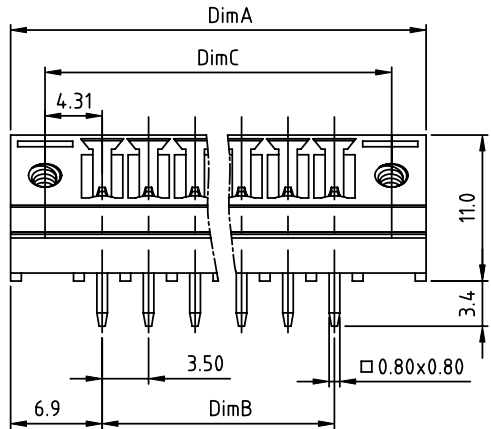

SECTION P-P

Material:

- Item (a) Male contact pin: Copper Tin plated
- Item (b) Terminal(housing): Thermoplastic (UL94V-0)
- Item (c) With flange nut: Brass ,M2.5

Electrical:

- Voltage rating: 300V/300V
- Current rating: 8A/10A
- Withstanding Voltage: 1.6 KV/2.5KV
- Operating temperature: -40°C to +115°C
- Soldering temperature: 260°C±5°C/5 Sec
- Safety Approval:

PART NO.: VK xx 12 x 0 00J0 G

$$\text{DimA}=(N-1)\times 3.5+13.8$$

$$\text{DimB}=(N-1)\times 3.5$$

$$\text{DimB}=(N-1)\times 3.5+8.62$$

N= number of poles

Poles	Tolerance
2-6p	±0.15
7-12p	±0.20
13-18p	±0.25
19-24p	±0.30

Solid block	No. of poles	Color	RoHS compliant (lead<4%) In copper Alloy
0	2	Black (RAL9005)	
1	3	Red (RAL3001/D)	
2	4	Orange(RAL2011/P)	
3	5	Yellow(RAL1018/A)	
4	6	Green(RAL6018/T)	
5	8	Blue (RAL5015/A)	
6	9	Grey(RAL7035/D)	
7	9	White(RAL1102)	
8	24	Green(RAL6018/U)	

mat'l. code				surface ASME Y14.5	tolerance ASME Y14.5	projection	product family
ltr	ecn	no	dr	date	tolerances unless otherwise specified		TERMINAL BLOCK
					angles	MM	title
					X±0.5		TERMINAL BLOCK
					X.X±0.3		PLUGGABLE SOCKET,45DEGREE INLET,WITH FLANGE
					X*±1"	scale	dwg no
					dr EVIN ZHONG 042214		sheet 1 of 1
					enr EVIN ZHONG 042214		size
					chr HANKE FENG 042214		VKxx12x000J0G
					appd SHI JUN 042214		A4
							type
							CUSTOMER Drawing
sheet index	revision sheet	A					