

RECOMMENDED PCB LAYOUT

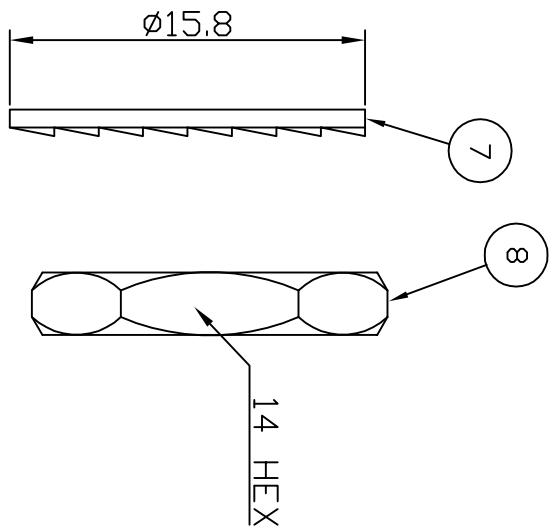

Electrical Characteristics

Nominal Impedance: 50 ohms
 Frequency Range: DC to 4 GHz
 VSWR: 2:1 maximum
 Operating Voltage (rms): 500 V maximum at sea level
 Dielectric Withstand Voltage (rms): 1500 V maximum at sea level
 Center Contact Resistance: 3 milliohms maximum
 Outer Contact Resistance: 2 milliohms maximum
 Insulation Resistance: 5000 megohms minimum
Mechanical Characteristics
 Mating Cycles: 500 cycles minimum

Environmental Characteristics

Temperature Range: -40 °C to +85 °C

PART	DESCRIPTION
1	Shell Zinc Alloy, nickel plated
2	Body P.B.T. UL94V-0 (White)
3	Dielectric Polypropylene
4	Ground Terminal Brass, tin plated
5	Socket Contact Phosphor Bronze, gold plated
6	Mount Post Brass, tin plated >5 Microns
7	Lock Washer Iron, nickel plated
8	Hex Nut Brass, nickel plated

Posts and contact dimension change	JC	11	09 July 15
ECN 2015-005	JC	10	28 May 15
Text Change	JC	9	24 Jan 13
PCB Mounting Dimensions Corrected	LB	8	21 Jan 09
Complete Update	KA	7	13 Mar 08
Updated Address	KA	6	22 Feb 08
CAD Issue	SN	5	05 Feb 02
Added UL Numbers	AT	4	01 June 99
DESCRIPTION OF REVISION	APPVD	ISS	DATE

TITLE:

**BNC R/A PCB Mount Jack
(low profile)**

PART NUMBER:

VB1211

SCALE: Not To Scale
 DIMENSIONS: mm
 TOLERANCES: ± 0.2mm unless otherwise stated

DRAWN BY: S Nash
 CHECKED BY: S Nash
 APPROVED BY: M Nielsen
 DATE: 05 Feb 02



11 Bilton Road,
 Chelmsford Essex,
 CM1 2UP, UK.
 Tel: +44 (0) 1245 359515
 Fax: +44 (0) 1245 359338