

NOTE 2

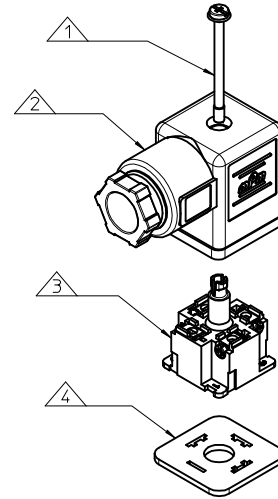

ITEM	DESCRIPTION
1	SCREW
2	COVER ASSEMBLY
3	INSERT ASSEMBLY
4	GASKET

C81311N62**

SERIES _____
 C81= INTERNAL THREAD FORM A
 POLES _____
 2= 2 POLE, 3= 3 POLE
 THREAD SIZE _____
 09= PG9 11=PG11, 12= 1/2" GAS, M6=M16x1.5, M0=M1201.5
 MATERIAL AND HOUSING COLOUR _____
 G= PA6 GRAY, N= PA6 BLACK, W= PA6 BLACK V0, T= TRANSPARENT
 EARTH POSITION _____
 0= UNMOUNTED, 2= H12, 3= H3, 6= H6, 9= H9

SCREW AND GASKET _____
 1= NBR PROFILE GASKET & SCREW
 2= NBR FLAT GASKET & SCREW
 3= WHITE SILICON PROFILE GASKET & SCREW
 4= WHITE SILICON FLAT GASKET & SCREW
 R= INTEGRATED GASKET & SCREW WITH GROMMET, NOT ASSEMBLED
 G= NO GASKET, STANDARD SCREW

NON STANDARD COMPONENTS _____
 14= SINGLE PACKED IN NEUTRAL BAG

NOTES

- PLEASE SEE SHEET 2 FOR CURRENTLY CONFIGURED PART NUMBERS. FOR SPECIFIC PART NUMBERS PLEASE CONTACT SALES OR CONSULT THE INTELLIGENT PART NUMBERS IN THE TABLE ATTACHED.
- EARTH POSITION SHOWN, H6.
- FOR PACKAGING SEE PACKAGING SPEC PK-121023-C81
- PRODUCT SPEC: SEE PS-12101-001
- P/N 1210230637 SHOWN FOR ILLUSTRATION PURPOSES ONLY

LAST INSPECTION NUMBER 2

ADD P/N EC NO: IPG2015-1444 DRWN:POWNER 2015/02/18 CHKD:DMAHER 2015/02/26 APPR:STGERIEFIN 2015/03/05	DESCRIPTION REV	QUALITY SYMBOLS ▽=0 ▽=0		GENERAL TOLERANCES (UNLESS SPECIFIED) mm INCH 4 PLACES ± --- ± --- 3 PLACES ± --- ± --- 2 PLACES ± 0.10 ± --- 1 PLACE ± 0.20 ± --- ANGULAR ± 2 °		DIMENSION STYLE MM ONLY		SCALE 1.5:1		DESIGN UNITS METRIC		THIRD ANGLE PROJECTION	
		DRAFT WHERE APPLICABLE MUST REMAIN WITHIN DIMENSIONS		DRAWN BY DATE OSHEA 2011/05/23		TITLE INTERNAL THREAD C81 SERIES							
		APPROVED BY DATE EFOLAN 2011/06/14		MATERIAL NO. SEE SHEET 2		DOCUMENT NO. SD-121023-008		SHEET NO. 1 OF 2					
		THIS DRAWING CONTAINS INFORMATION THAT IS PROPRIETARY TO MOLEX INCORPORATED AND SHOULD NOT BE USED WITHOUT WRITTEN PERMISSION											

PART NO	mPm NO	DESCRIPTION
1210230618	C81211G21	TYPE A 2P PG11 GRAY, NBR PROFILE GASKET
1210230620	C81211N21	TYPE A 2P PG11 BLACK, NBR PROFILE GASKET
1210230633	C81311N21	TYPE A 3P PG11 BLACK, NBR PROFILE GASKET
1210230808	C81309N2R	TYPE A 3P PG9 BLACK, INTEGRATED NBR GASKET & IP67 SCREW NOT ASSEMBLED
1210230629	C81309N21	TYPE A 3P PG9 BLACK, NBR PROFILE GASKET
1210230627	C81309G21	TYPE A 3P PG9 GRAY, NBR PROFILE GASKET
1210230635	C81311N24	TYPE A 3P PG11 BLACK, WHITE SILICON FLAT GASKET
1210230694	C813M0N21	TYPE A 3P M20x1.5 BLACK, NBR PROFILE GASKET
1210230612	C81209N21	TYPE A 2P PG9 BLACK, NBR PROFILE GASKET
1210230616	C81209N62	TYPE A 2P PG9 BLACK, NBR FLAT GASKET
1210230707	C813M6N21	TYPE A 3P M16x1.5 BLACK, NBR PROFILE GASKET
1210230781	C81312N23	TYPE A 3P 1/2" GAS BLACK, WHITE SILICON PROFILE GASKET
1210230819	C81312N22	TYPE A 3P 1/2" GAS BLACK, NBR FLAT GASKET
1210230637	C81311N62	TYPE A 3P PG11 BLACK, NBR FLAT GASKET
1210230632	C81311G22	TYPE A 3P PG11 GRAY, NBR FLAT GASKET
1210230631	C81311G21	TYPE A 3P PG11 GRAY, NBR PROFILE GASKET
1210230630	C81309N22	TYPE A 3P PG9 BLACK, NBR FLAT GASKET
1210230687	C812M6N21	TYPE A 2P M16x1.5 BLACK, NBR PROFILE GASKET
1210230626	C81212N21	TYPE A 2P 1/2" GAS BLACK, NBR PROFILE GASKET
1210230624	C81211N62	TYPE A 2P PG11 BLACK, NBR FLAT GASKET
1210230623	C81211N24	TYPE A 2P PG11 BLACK, WHITE SILICON FLAT GASKET
1210230690	C81211N2114	TYPE A 2P PG11 BLACK, NBR PROFILE GASKET SINGLE BAGGED IN NEUTRAL BAG
1210230611	C81209G21	TYPE A 2P PG9 GRAY, NBR PROFILE GASKET
1210230622	C81211N23	TYPE A 2P PG11 BLACK, WHITE SILICON PROFILE GASKET
1210230836	C81309N24	TYPE A 3P PG9 BLACK, WHITE SILICON FLAT GASKET
1210230659	C81209T21	TYPE A 2P PG9 TRANSPARENT, NBR PROFILE GASKET
1210230634	C81311N22	TYPE A 3P PG11 BLACK, NBR FLAT GASKET
1210230860	C81309N2G	TYPE A 3P PG9 BLACK, NO GASKET, STANDARD SCREW
1210230871	C81309W21SA	TYPE A 3P PG9 BLACK, NBR FLAT GASKET & SCREW

SEE SHEET 1 EC NO: IFC2015-1444 DRAWN BY: POWNER 2015/02/18 CHKD: DMAHER 2015/02/26 APPR: SUGRUFFIN 2015/03/05	DESCRIPTION H	QUALITY SYMBOLS ▽=0 ▽=0	GENERAL TOLERANCES (UNLESS SPECIFIED) <table border="1"> <thead> <tr> <th></th> <th>mm</th> <th>INCH</th> </tr> </thead> <tbody> <tr><td>4 PLACES</td><td>± .005</td><td>± .0004</td></tr> <tr><td>3 PLACES</td><td>± .008</td><td>± .0003</td></tr> <tr><td>2 PLACES</td><td>± 0.10</td><td>± .004</td></tr> <tr><td>1 PLACE</td><td>± 0.20</td><td>± .008</td></tr> </tbody> </table>		mm	INCH	4 PLACES	± .005	± .0004	3 PLACES	± .008	± .0003	2 PLACES	± 0.10	± .004	1 PLACE	± 0.20	± .008	DIMENSION STYLE MM ONLY	SCALE 2:1	DESIGN UNITS METRIC	THIRD ANGLE PROJECTION
			mm	INCH																		
		4 PLACES	± .005	± .0004																		
		3 PLACES	± .008	± .0003																		
2 PLACES	± 0.10	± .004																				
1 PLACE	± 0.20	± .008																				
DRAFT WHERE APPLICABLE MUST REMAIN WITHIN DIMENSIONS			<table border="1"> <thead> <tr> <th>DRAWN BY</th> <th>DATE</th> <th>TITLE</th> </tr> </thead> <tbody> <tr> <td>OSHEA</td> <td>2011/05/23</td> <td rowspan="3" style="text-align: center;">INTERNAL THREAD C81 SERIES</td> </tr> <tr> <td>CHECKED BY</td> <td>DATE</td> </tr> <tr> <td>DMAHER</td> <td>2011/05/30</td> </tr> </tbody> </table>	DRAWN BY	DATE	TITLE	OSHEA	2011/05/23	INTERNAL THREAD C81 SERIES	CHECKED BY	DATE	DMAHER	2011/05/30	MOLEX INCORPORATED								
DRAWN BY	DATE	TITLE																				
OSHEA	2011/05/23	INTERNAL THREAD C81 SERIES																				
CHECKED BY	DATE																					
DMAHER	2011/05/30																					
<table border="1"> <thead> <tr> <th>APPROVED BY</th> <th>DATE</th> <th>MATERIAL NO.</th> <th>DOCUMENT NO.</th> <th>SHEET NO.</th> </tr> </thead> <tbody> <tr> <td>EFOLAN</td> <td>2011/06/14</td> <td></td> <td>SD-121023-008</td> <td>2 OF 2</td> </tr> </tbody> </table>			APPROVED BY	DATE	MATERIAL NO.	DOCUMENT NO.	SHEET NO.	EFOLAN	2011/06/14		SD-121023-008	2 OF 2										
APPROVED BY	DATE	MATERIAL NO.	DOCUMENT NO.	SHEET NO.																		
EFOLAN	2011/06/14		SD-121023-008	2 OF 2																		
			SIZE 	THIS DRAWING CONTAINS INFORMATION THAT IS PROPRIETARY TO MOLEX INCORPORATED AND SHOULD NOT BE USED WITHOUT WRITTEN PERMISSION																		