

THIS DRAWING IS A CONTROLLED DOCUMENT.

PART NUMBER	REV	FIRST USED
466627-1	H	565435-5
466627-2	H	354500-1

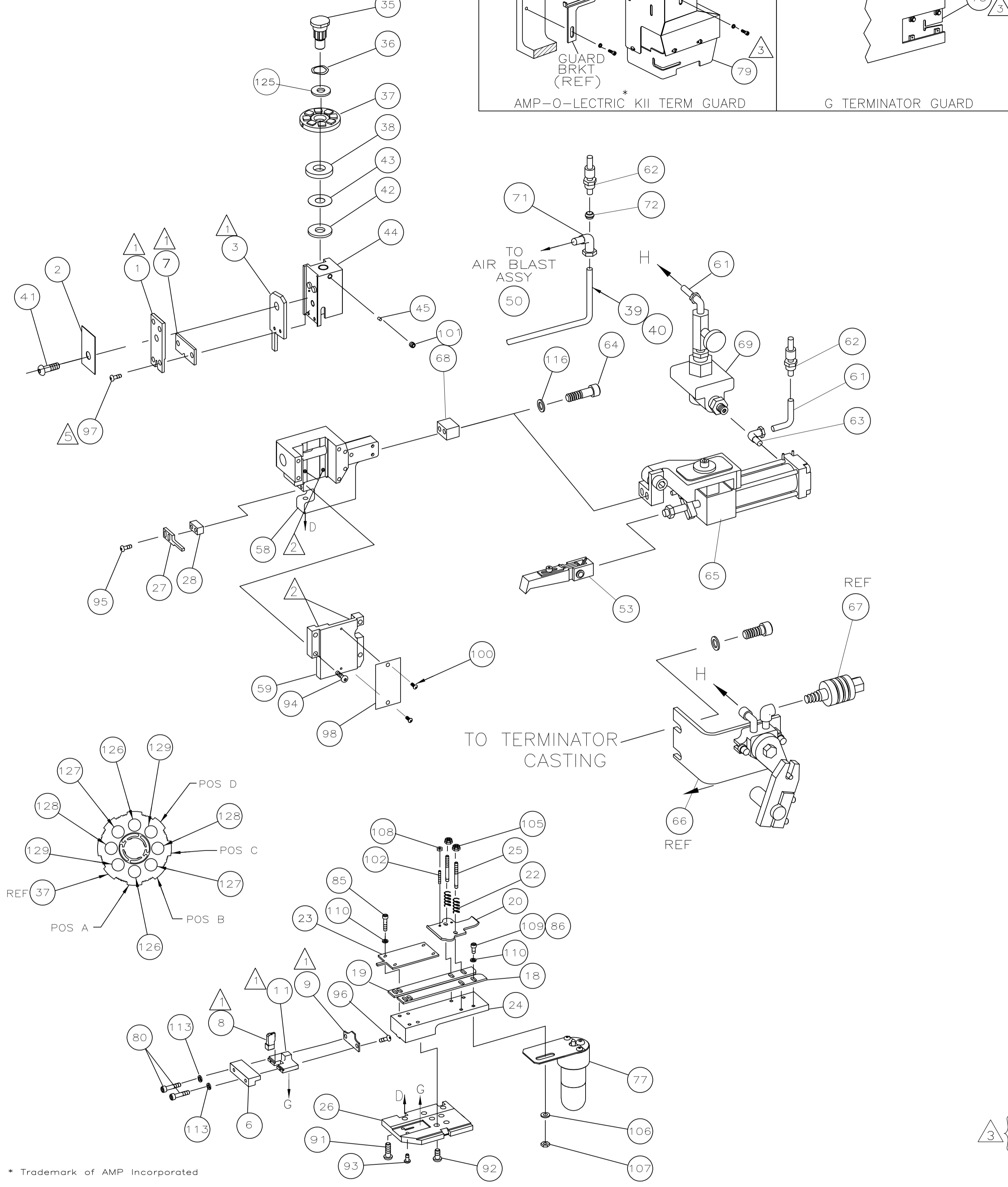

TERMINAL NAME:	AMPLIVAR SPLICE
62305	
TERM APPL SPEC	114-2003

CRIMPING DATA			
PAD LTR	CRIMP HEIGHT	WIRE SIZE CMA	
A	.057±.002 [1.45±0.05mm]	2400-3000	
B	.052±.002 [1.32±0.05mm]	1400-2200	
C	.047±.002 [1.19±0.05mm]	600-1200	
D	NOT	USED	
CRIMP	SIZE	TYPE	RANGE
WIRE	110 [2.79mm]	F	600-3000
INSUL	-	-	-
FEED	APPL INST 408-8039	SET UP GAGE	LAYOUT L1597
WIRE STRIP LENGTH		.279-.341	

-1	BENCH MODEL K	AIRFEED
-2	BENCH MODEL G	AIRFEED

2	2	-	6-354779-2	PIN, WIRE DISC (.3300)C	129	
2	2	-	5-354779-2	PIN, WIRE DISC (.3250)B	128	
2	2	-	4-354779-2	PIN, WIRE DISC (.3200)A	126	
1	1	-	986950-1	WASHER, FLAT PRECISION	125	
1	1	-	217238-1	GENERAL INSTRUCTION PACKAGE	124	
1	1	-	4088039	EF APPL INST 408-8039	123	
					122	
					121	
					120	
					119	
					118	
					117	
2	2	-	21024-5	WASHER, LOCK(NO.10)	116	
					115	
					114	
2	2	-	21024-3	WASHER, LOCK(NO.6)RET PL	113	
					112	
					111	
6	6	-	21024-4	WASHER, LOCK(NO.8)SHEAR BL	110	
1	1	-	2-21000-9	SCR, SHC(8-32x.75)ST GUIDE	109	
2	2	-	21018-4	NUT, HEX(4-40)DRAG	108	
1	1	-	21018-6	NUT, HEX(8-32)LUBRICATOR	107	
1	1	-	21055-6	WASHER, FLAT(NO.8)LUBE	106	
2	2	-	21022-2	NUT, HEX SL(8-32)DRAG STUD	105	
					104	
					103	
2	2	-	4-21078-8	SKT SKT SET (4-40x.75)DRAG	102	
1	1	-	21009-2	SCR, SKT SET(1/4-20x.25)RAM	101	
2	2	-	1-21002-3	SCR, BHC(4-40x.25)ID PLATE	100	
					99	
1	1	-	464249-1	PLATE, IDENTIFICATION	98	
2	2	-	2-21002-8	SCR, BHC(10-32x.63)RAM	97	
2	2	-	1-21002-6	SCR, BHC(6-32x.25)GUIDE PLATE	96	
2	2	-	8-21002-9	SCR, BHC(8-32x1.00)STRIPPER	95	
4	4	-	2-21002-9	SCR, BHC(10-32x.75)CAP	94	
2	2	-	2-22733-0	SCR, BHC(10-32x.38 LW)ANVIL	93	
4	4	-	3-21002-3	SCR, BHC(1/4-20x.50)ST GD PL	92	
3	3	-	2-22733-8	SCR, BHC(1/4-20x.62)HSG	91	
					90	
					89	
					88	
					87	
1	1	-	2-21000-6	SCR, SHC(8-32x.38)STRIP GUIDE	86	
4	4	-	2-21002-2	SCR, BHC(8-32x.50)STRIP GUIDE	85	
					84	
					83	
					82	
					81	
					80	
2	2	-	1-21000-9	SCR, SKT CAP(6-32x.38)PLATE RET	79	
-	1	-	460980-2	GUARD ASSY	78	
-	-	-	679532-1	INSERT, GUARD	77	
-	1	-	1-465184-7	LUBRICATOR ASSY	76	
					75	
					74	
					73	
-	1	-	992638-1	SLEEVE, BRASS	72	
-	1	-	22317-3	ELBOW, COPPER TUBE	71	
					70	
					69	
					68	
					67	
					66	
					65	
					64	
					63	
					62	
					61	
					60	
					59	
					58	
					57	
					56	
					55	
					54	
4	1	1	-	460680-7	FEED FINGER ASSY	53
					52	
					51	
					50	
-	1	-	455350-1	AIR BLAST ASSY	49	
					48	
					47	
					46	
1	1	-	690191-1	PLUG, NYLON	45	
1	1	-	459586-1	RAM	44	
1	1	-	690125-1	WASHER, LAMINATED	43	
1	1	-	690124-1	WASHER, RAM	42	
1	1	-	7-21002-9	BOLT, CRIMPER(5/16-24x1.00)	41	
1	-	-	318848-1	AIR BLAST ASSY	40	
1	1	-	689446-2	TUBE, AIR BLAST	39	
1	1	-	690223-2	DISC, SPACER	38	
1	1	-	354777-1	WIRE DISC, PLASTIC	37	
1	1	-	22480-5	WASHER, SPRING	36	
1	1	-	690212-1	POST, RAM	35	
					34	
					33	
					32	
					31	
					30	
					29	
1	1	-	3-690451-9	SPACER, STRIPPER	28	
1	1	-	460276-1	STRIPPER	27	
1	1	-	459584-1	PLATE, BASE	26	
2	2	-	22354-8	DRAG, STUD	25	
1	1	-	462931-1	PLATE, STRIP GUIDE	24	
1	1	-	462932-1	PLATE, STRIP HOLD	23	
2	2	-	4-22281-1	SPRING, DRAG	22	
					21	
1	1	-	462925-1	DRAG, STOCK	20	
1	1	-	462929-3	GUIDE, STRIP (REAR)	19	
1	1	-	462930-3	GUIDE, STRIP (FRONT)	18	
					17	
					16	
					15	
					14	
					13	
					12	
1	1	1	-	459583-3	BODY, ANVIL	11
					10	
1	1	-	459684-3	PLATE GUIDE, RETAINING	9	
1	1	-	459582-4	ANVIL	8	
1	1	-	459581-1	BLADE, SLUG	7	
1	1	-	459580-1	PLATE, RET	6	
					5	
					4	
					3	
1	1	-	459585-1	CRIMPER, WIRE	2	
					1	

4	-	1	-	692655-5	AIR FEED VALVE ASSY	70
	1	1	-	461690-1	SPACER, AIR FEED	69
	-	REF	-	24042-2	VALVE, SHUT OFF	67
4	-	REF	-	692655-6	AIR FEED VALVE ASSY	66
	1	1	-	460277-1	AIR FEED ASSY	65
	2	2	-	4-21000-3	SCR, SHC 10-32x2.00 AIR ASSY	64
	1	-	-	22294-6	ELBOW, TUBING 1/8NPT - 1/4 T	63
	1	-	-	23238-1	QUICK DISCONNECT	62
	12.00	12.00	IN	27319-4	TUBING, POLY-FLO Ø.25	61
						60
	1	1	-	462926-1	CAP, RAM	59
	1	1	-	453736-1	HOUSING	58
						57
						56
						55
						54
4	1	1	-	460680-7	FEED FINGER ASSY	53
						52
						51
	-	1	-	455350-1	AIR BLAST ASSY	50
						49
						48
						47
						46
	1	1	-	690191-1	PLUG, NYLON	45
	1	1	-	459586-1	RAM	44
	1	1	-	690125-1	WASHER, LAMINATED	43
	1	1	-	690124-1	WASHER, RAM	42
	1	1	-	7-21002-9	BOLT, CRIMPER(5/16-24x1.00)	41
	1	-	-	318848-1	AIR BLAST ASSY	40
	1	1	-	689446-2	TUBE, AIR BLAST	39
	1	1	-	690223-2	DISC, SPACER	38
	1	1	-	354777-1	WIRE DISC, PLASTIC	37
	1	1	-	22480-5	WASHER, SPRING	36
	1	1	-	690212-1	POST, RAM	35
						34
						33
						32
						31
						30
						29
	1	1	-	3-690451-9	SPACER, STRIPPER	28
	1	1	-	460276-1	STRIPPER	27
	1	1	-	459584-1	PLATE, BASE	26
	2	2	-	22354-8	DRAG, STUD	25
	1	1	-	462931-1	PLATE, STRIP GUIDE	24
	1	1	-	462932-1	PLATE, STRIP HOLD	23
	2	2	-	4-22281-1	SPRING, DRAG	22
						21
	1	1	-	462925-1	DRAG, STOCK	20
	1	1	-	462929-3	GUIDE, STRIP (REAR)	19
	1	1	-	462930-3	GUIDE, STRIP (FRONT)	18
						17
						16
						15
						14
						13
						12
1	1	1	-	459583-3	BODY, ANVIL	11
						10
1	1	-	459684-3	PLATE GUIDE, RETAINING	9	
1	1	-	459582-4	ANVIL	8	
1	1	-	459581-1	BLADE, SLUG	7	
1	1	-	459580-1	PLATE, RET	6	
						5
						4
						3
1	1	-	459585-1	CRIMPER, WIRE	2	
						1

- 1 RECOMMENDED SPARE PARTS.
- 2 GREASE LIGHTLY.
- 3 GUARD MUST BE IN PLACE WHEN OPERATING APPLICATOR IN BENCH MACHINE.
- 4 SEE DRAWING FOR COMPONENTS
- 5 SET-UP WIRE
PAD A #18 STRANDED & #20 MAGNET.
PAD B #20 STRANDED & #21 MAGNET.
PAD C #22 STRANDED & #24 MAGNET.

QTY	REQD	PER	ASSY	PARTS LIST
-----	------	-----	------	------------

QTY	REQD	PER	ASSY	PARTS LIST
-----	------	-----	------	------------

THIS INFORMATION IS CONFIDENTIAL AND PROPRIETARY TO TYCO ELECTRONICS CORPORATION AND ITS WORLDWIDE SUBSIDIARIES AND AFFILIATES. IT MAY NOT BE DISCLOSED TO ANY OTHER PERSON OR ENTITY WITHOUT THE EXPRESS WRITTEN AUTHORIZATION FROM TYCO ELECTRONICS CORPORATION, HARRISBURG, PENNSYLVANIA, USA.

LOC A
DIST 66