

LAYOUT DIMENSIONS (after plating)
CONNECTOR SIDE VIEW

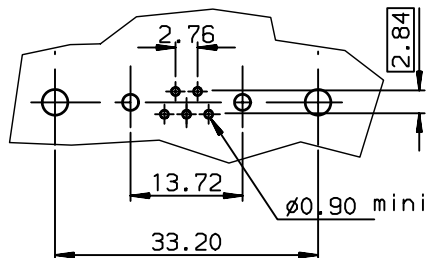

LEAD FREE PART NUMBER

DA07W2S300A30LF	UNC 4.40
DAL7W2S300A30LF	M3
PART NUMBER	Threaded A

GENERAL CHARACTERISTICS AND ROHS INFORMATIONS:
SEE DRAWING C01-8639-0000

European Views

www.fciconnect.com		surface ISO 1302 ✓	tolerance std ISO 406 ISO 1101	projection mm	mm
TOLERANCES UNLESS OTHERWISE SPECIFIED					
Dr	PESSON	2005/11/24	ANGULAR	0.X ±0.1	size A3
Eng	PESSON	2005/11/24	LINEAR	0.XX ±0.1	Scale 1.5
Chr	LEGARE	2005/11/24	0.XX' ±2'	0.XXX ±0.1	ECN LS06-0095
Appr	LEGARE	2005/11/24	Product family	D-SUB	Spec ref -
FCI title			SOCKET CONNECTOR WITH STRAIGHT CONTACTS AND 2 POWERS CONTACTS		Rev. B
catalog no			-		dwg no C01-8639-2254
CUSTOMER			sheet 1 of 1		

rev	ecn no	dr	date
A	LS05-0106	MPE	2005/11/24
B	LS06-0095	LGO	2006/06/15
-	-	-	-
-	-	-	-
-	-	-	-
-	-	-	-



Copyright FCI.