

P.C. MOUNTING

O.P. (MM)	P.T. (MM)
9.1 ±0.8	3.6 MAX

O.P. = OPERATING POINT
 P.T. = PER-TRAVEL

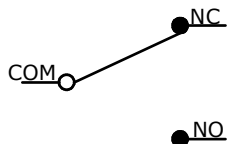

CIRCUIT: SPDT

NOTES:

- ALL DIMENSIONS IN MM [INCH]
- GENERAL TOLERANCE: X.X=±0.4
X.XX=±0.25
- RATING: 5A @125/250VAC UL, CUL, VDE APPROVED
- ▲ OPERATING FORCE: 25±12 GRAMS
- OPERATING TEMP: -25°C TO 85°C
- ELECTRICAL LIFE: 50,000 CYCLES MIN.
- MECHANICAL LIFE: 1,000,000 CYCLES TYP.
- INSULATION RESISTANCE: 100 MEGA-OHMS
- DIELECTRIC STRENGTH: 1000VAC 1 MINUTE (INITIAL VALUE)
- CONTACT RESISTANCE: 100 mΩ MAX.
- ▲ DENOTES CRITICAL PARAMETER.
- 2002/95/EC (ROHS) COMPLIANT

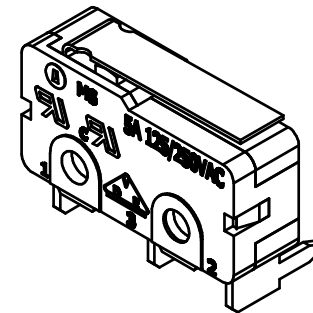
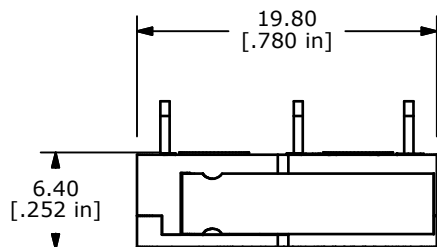

ISOMETRIC

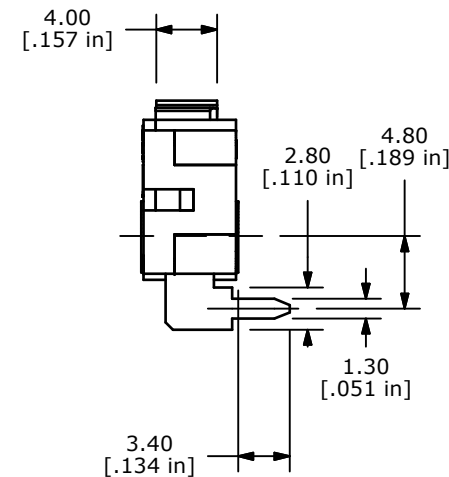
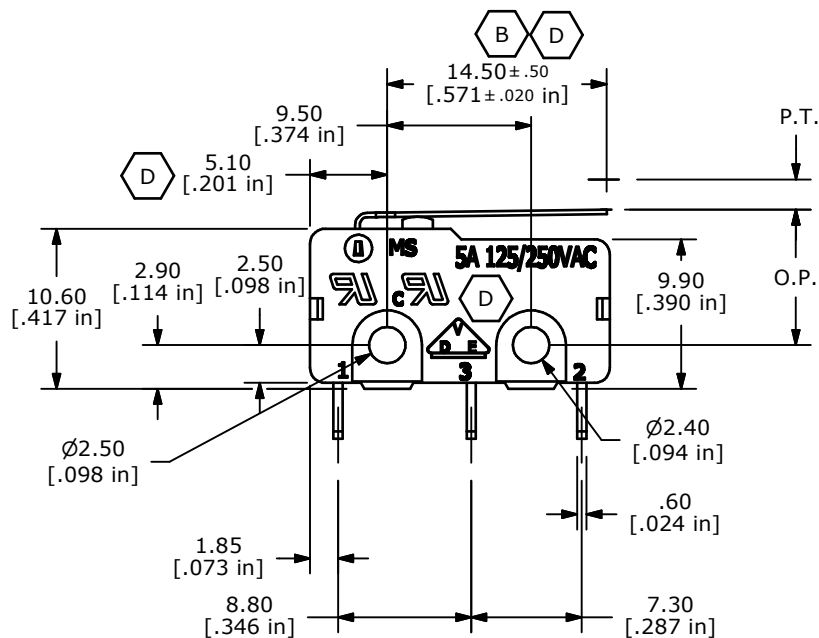

REV	PCR NO	DESCRIPTION	DATE	BY
D	15658	CHANGES NOTED	1/4/06	PH
C	15283	EDIT PC MOUNT, ROHS NOTE	9/15/05	PH
B	15090	CORRECTED NOTE AND DIMENSION	7/12/05	JB
A	15042	RELEASED FOR PRODUCTION	6/30/05	JB



TITLE MS0850501F025V1A

SCALE	DATE	DR	DWG	REV
2:1	6/30/2005	JB	Q970017	D

THE INFORMATION CONTAINED IN THIS DOCUMENT IS PROPRIETARY TO E-SWITCH AND IS NOT TO BE COPIED OR TRANSFERRED