

Printed-circuit board connector - MSTB 2,5/ 4-GF-5,08 EX - 1795682

Please be informed that the data shown in this PDF Document is generated from our Online Catalog. Please find the complete data in the user's documentation. Our General Terms of Use for Downloads are valid (<http://download.phoenixcontact.com>)

Header, Nominal current: 12 A, Nominal current (Ex): 12 A, Nominal voltage (Ex): 176 V, Number of positions: 4, Pitch: 5.08 mm, Color: green, Contact surface: Tin, Assembly: Soldering



The figure shows a 10-position version of the product

Product Features

- ✓ For more application and installation notes for plug-in connectors for the Ex area, visit www.phoenixcontact.net/products
- ✓ Ex approval for voltages up to 176 V



Key commercial data

Packing unit	1 PCE
GTIN	 4 046356 635882
Custom tariff number	85366990
Country of origin	GERMANY

Technical data

Dimensions / positions

Pitch	5.08 mm
Dimension a	15.24 mm
Number of positions	4
Pin dimensions	1 x 1 mm
Hole diameter	1.4 mm

Technical data

Range of articles	MSTB 2,5/..-GF-EX
Insulating material group	I
Connection in acc. with standard	EN-VDE

Printed-circuit board connector - MSTB 2,5/ 4-GF-5,08 EX - 1795682

Technical data

Technical data

Nominal current I_N	12 A
Nominal voltage U_N	250 V
Insulating material	PA
Inflammability class according to UL 94	V0
Color	green

Classifications

ETIM

ETIM 4.0	EC002637
ETIM 5.0	EC002637

UNSPSC

UNSPSC 11	39121409
UNSPSC 12.01	39121409
UNSPSC 13.2	39121409
UNSPSC 6.01	30211810
UNSPSC 7.0901	39121409

eCl@ss

eCl@ss 4.0	272607xx
eCl@ss 4.1	27260701
eCl@ss 5.0	27260701
eCl@ss 5.1	27260701
eCl@ss 6.0	27260704
eCl@ss 7.0	27440402

Drawings

Drilling diagram

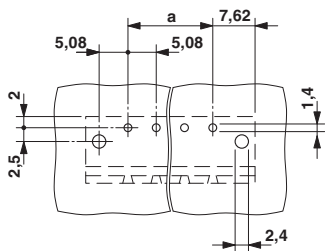

Dimensioned drawing

